

PS - 12260

12v/26.0Ah Flame retardant battery

VANDERBILT



Key Features include:

- UL94-V0 flame retardant case
- Compliant with EN60950-1 requirements for enclosures
- Tested & approved to latest industry standards
- Maintenance free sealed lead battery
- Low self-discharge rate
- Operational in any orientation
- Low internal resistance
- High long-term stability
- High capacity
- 100% recyclable

Description

■ Application

The maintenance free, sealed lead battery of the PS... Series are suitable for protection systems. They can be used for intrusion, fire and access control systems to guarantee their continuous operation in case of a power failure.

■ Features

The capacity of the maintenance free lead batteries is the product of the discharge current (A) and the discharge time (h) specified in ampere hour (Ah), whereas the capacity and the discharge voltage curve depend directly on the discharge current (see table below).

Several batteries can be connected in parallel to increase the total capacity, but it is required to use batteries with the same nominal capacity and voltage.

If possible the correct size of battery should be chosen for the load of the system.

The operation of the battery below the end-point voltage will lead to a deep discharge of the battery. Deep discharged batteries cannot provide the initial capacity until they are fully recharged. The batteries of the PS... Series are protected against a deep discharge, which means they can be charged up to their nominal capacity again after a deep discharge, without any degradation of the capacity. Deep discharge situations should be avoided to help protect the life of the battery.

PS - 12260

12v/26.0Ah Flame retardant battery

VANDERBILT

■ Dimensions (mm)

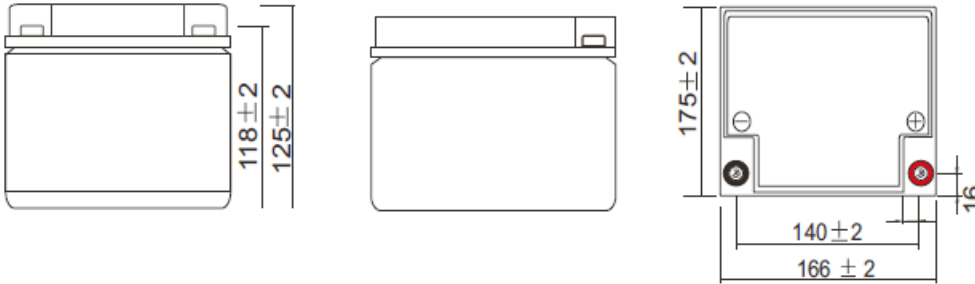

■ Standard terminal (mm)

T12 Terminal

Threaded insert 5mm Stud

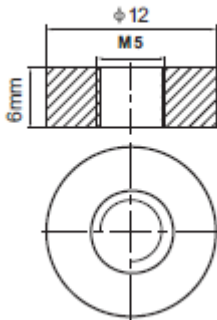

Torque: 2.0 - 3.0 Nm

Constant Current Discharge (Amperes) at 25°C (77°F)

F.V/Time	10min	15min	20min	30min	45min	1h	2h	3h	4h	5h	6h	8h	10h	20h
1.85V/cell	31.0	25.8	22.0	18.0	13.6	11.4	7.28	5.77	4.67	3.78	3.31	2.65	2.27	1.26
1.80V/cell	39.6	31.2	26.0	21.2	15.8	12.8	7.94	6.21	4.99	4.06	3.56	2.82	2.40	1.27
1.75V/cell	43.5	34.1	28.0	22.0	16.4	13.4	8.24	6.32	5.11	4.16	3.65	2.86	2.42	1.28
1.70V/cell	47.4	36.4	29.4	22.9	17.1	13.8	8.57	6.50	5.24	4.27	3.73	2.90	2.45	1.31
1.65V/cell	51.1	38.7	31.3	24.2	17.5	14.3	8.81	6.77	5.42	4.39	3.81	2.95	2.50	1.32
1.60V/cell	55.5	41.4	33.3	25.5	18.2	14.8	9.10	6.98	5.59	4.53	3.89	2.98	2.52	1.33

Constant Power Discharge (Watts/Cell) at 25°C (77°F)

F.V/Time	10min	15min	20min	30min	45min	1h	2h	3h	4h	5h	6h	8h	10h	20h
1.85V/cell	58.3	49.1	42.3	34.9	26.6	22.4	14.4	11.4	9.30	7.54	6.63	5.33	4.56	2.54
1.80V/cell	73.6	58.5	49.3	40.6	30.7	25.0	15.6	12.2	9.88	8.06	7.09	5.64	4.83	2.56
1.75V/cell	79.6	63.2	52.5	41.8	31.6	26.0	16.1	12.4	10.1	8.24	7.26	5.72	4.87	2.58
1.70V/cell	84.8	66.5	54.8	43.2	32.7	26.7	16.7	12.7	10.3	8.43	7.40	5.80	4.91	2.63
1.65V/cell	90.7	70.2	57.7	45.3	33.3	27.4	17.1	13.2	10.6	8.64	7.54	5.88	5.01	2.66
1.60V/cell	96.3	73.9	60.8	47.5	34.5	28.3	17.6	13.6	10.9	8.90	7.68	5.92	5.05	2.67

VANDERBILT

PS - 12260

12v/26.0Ah Flame retardant battery

VANDERBILT

■ Discharge Characteristics (25°C, 77°F)

Rated Capacity	20hr Rate (1.80V/cell) 10hr Rate (1.80V/cell) 5hr Rate (1.75V/cell) 3hr Rate (1.75V/cell) 1hr Rate (1.60V/cell)	26AH 24AH 20.8AH 19.0AH 14.8AH	Constant Voltage Charge	Cycle	Initial Charging Current Less than 6.5A Voltage 14.40V ~ 15.0V At 25°C (77°F)
Capacity Affected by Temperature	40 °C (104°F) 25°C (77°F) 0°C (32°F)	103% 100% 86%		Standby	Recommended Charge Current less than 6.5A Voltage 13.5V 13.8V at 25°C (77°F)

■ Technical Data

Nominal voltage	12V
Nominal capacity (20HR)	26.0Ah
Housing	
- Material	Thick walled ABS
- Flammability rating	UL94-V0
Transportation	Non-hazardous (air / sea / rail / road)
Operating temperature	
- Charge	-15°C to +50°C
- Discharge	-20°C to +60°C
Storage temperature (fully charged)	-20°C to +60°C
Life expectancy	3-5 years under float charge conditions
Internal resistance	14mΩ
Dimensions	
- Length	166 ± 2 mm
- Width	175 ± 2 mm
- Container height	118 ± 2 mm
- Terminal height	125 ± 2 mm
Terminal type	T12
Approvals	VdS – G 103145

■ Ordering Data

Type	Art. No.	Designation	Weight
PS12260	N54545-Z159-A100	Battery 12v/26.0Ah Flame Ret.	7.8Kg

Issued by
Vanderbilt
Clonshaugh Business and
Technology Park
Clonshaugh
Dublin 17
Ireland
www.vanderbiltindustries.com

Data and design subject to change without notice.
Supply subject to availability.

VANDERBILT